

Connections Din25201 Stainless Steel 304 Double Sided Tooth Dual Stacked Self-Locking Washer

Our Product Introduction

for more products please visit us on metalscrewfastener.com

Basic Information

- Place of Origin: Guangdong, China
- Brand Name: FineExpress
- Model Number: copper washer
- Minimum Order Quantity: 50000
- Price: \$0.19/pieces 100-9999 pieces



Product Specification

- Finish: Black, ZINC, Plain
- Style: Steel Washer
- Material: Stainless Steel, Steel, 18-8 STAINLESS STEEL, Bronze
- Application: Heavy Industry, Retail Industry, Automotive Industry, Electrical,electronics,cabint
- Standard: No Standard
- Reliability Test: Mechanical Dimentions,salt Spray Endurance Test
- Service: Customized OEM
- Sample: Available
- Function: Connection,Fastening And Decoration
- MOQ: 1 Piece In Stock, 50,000 Pcs Customized
- Delivery Time: In Stock 5~7 Working Days, Customized 15~25 Working Days
- Highlight: **stainless steel 304 metal washer,**
stainless steel 304 metal flat washer

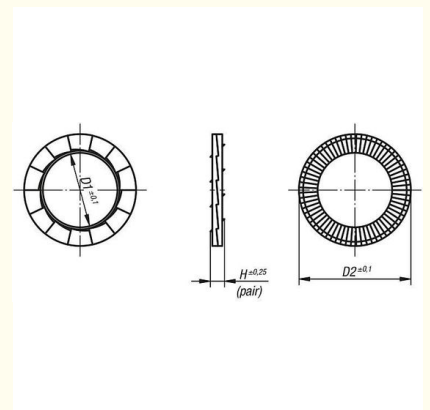

More Images



Product Description

Connections Din25201 Stainless Steel 304 Double Sided Tooth Dual Stacked Self-Locking Washer

FINEX | Fine and Express FASTENERS



Enhance the reliability and durability of your fastening applications with the **Connections Din25201 Stainless Steel 304 Double-Sided Tooth Dual Stacked Self-Locking Washer**. Designed to meet the rigorous DIN 25201 standard, this high-quality washer is crafted from premium **Stainless Steel 304**, ensuring exceptional corrosion resistance, strength, and longevity, even in demanding environments.

The **double-sided tooth design** provides superior grip and locking performance, preventing loosening caused by vibrations, thermal expansion, or dynamic loads. Its **dual-stacked construction** offers enhanced stability and load distribution, making it ideal for heavy-duty applications in industries such as automotive, aerospace, construction, and machinery.

Key Features:

Material: Stainless Steel 304 for excellent corrosion resistance and durability.

Design: Double-sided teeth for secure locking and vibration resistance.

Construction: Dual-stacked for improved load distribution and stability.

Standard: Complies with DIN 25201 for reliable performance.

Applications: Suitable for high-stress environments, including automotive, industrial, and construction projects.

Whether you're working on critical machinery or structural projects, this self-locking washer ensures a secure and long-lasting connection. Upgrade your fastening solutions with the **Connections Din25201 Stainless Steel 304 Double-Sided Tooth Dual Stacked Self-Locking Washer** – the ultimate choice for safety and performance.

FINEX | Fine and Express
FASTENERS



[Click Here To Start Customizing](#)
Customizable Hole Shape



Pozi



Phillips



**Anti-theft
Triangle**



Slotted



Hex Socket

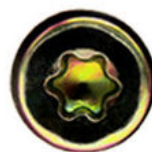

Torx



**Torx-internal
Tamber proof pin**



**H type
anti theft**



Tri-wing



**Two-Hole
Tamber proof**



**One way
anti theft**



**Square Slot
Combination**



**Phillips Slot
Combination**



**Slot 6 Lobe
Combination**



**Tri-wing internal
Tamber proof pin**





FINEX | Fine and Express
FASTENERS    

OEM **ODM**
ORIGINAL ORIGINAL
EQUIPMENT DESIGN
MANUFACTURER MANUFACTURER

What We Produce is Not Just a Screw. We Provide a Guarantee of Secure Fastening



Specification

More Detail Informations

Available Material

- 1.Stainless Steel: SS303, SS304, SS316, SS410, SS420;
 - 2.Carbon steel: C1006,C1010,C1018,C1022,C1035K,C1045;
 - 3.Brass: C3602,C3604,Hpb59,Hpb62,Hpb65,Hpb58,Hpb70 ;
 - 4.Aluminum: Al6061, Al6063 etc
- or as your requirements

Head type

CSK Head,Pan Head,Truss Head,Hexagon Head,Round Head,Oval Head,Button Head,Cap Head,Cheese Head,etc.

Hardness	Carbon Steel:HRC:28~35 ,HV450~700 Alloy Steel:HRC:32~39(grade10.9) HRC:39~44(grade12.9)
Finish	Zinc plated, Nickel plated, Bronze, Copper,Phosphate, Oxidation black, Passivation, Tin, Dacromet, Gold, Chrome, Silver, Phosphorization,Zinc-nickel alloy plated etc.
Sample Available	The sample is free of charge if we have the existing tooling,you only need to pay for the freight cost
Delivery time	Samples time 3-5 working days, Lead time 20-25 working days
Pricing Term	EXW Dongguan(FCA),FOB, CIF, CNF, DDU,etc.
Packing	Bulk in PE bag or Small boxes.then in carton .pallet
Payment term	TT (30% in advance as deposit, balance before delivery) , L/C, Western Union,PayPal etc
Management system	ISO9001:2015
Certificate	ISO,ROHS

Why Choose Us

NO1.Drive compariason



NO2.Torque comparison

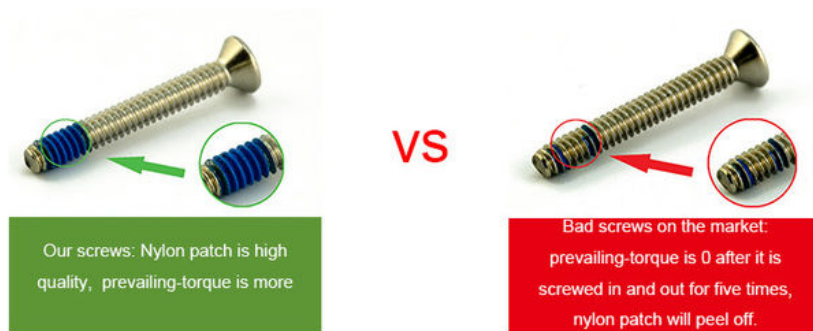

NO3.Screw Plating Comparison



Our screws: good finish, clear thread, even coating, bright appearance.

VS



Bad screws on the market: bad finish, uneven coating, thread is oxidized, the finish is blacked.

NO4.Screw Material Comparison



Our screws: we use quality carbon steel material, Chemical Element content in Steel meets the requirement of ISO standard, they won't be broken after 90° bent, high strength, good toughness requirement of ISO

VS



Bad screws on the market: bad carbon steel material, Chemical Element content in Steel doesn't meet the requirement of ISO standard, they will be easily broken after 90° bent, high strength and bad toughness.

NO5.Mechanical Properties comparison



Our self tapping screws: our screws have high strength, enough hardness, good toughness after heat treated, they won't be broken after bent.

VS



Bad screws on the market: they have high strength and bad toughness, thread will easily be broken, because the screws are not tempered.

NO6. Corrosion Resistance Comparison of SUS304



Our SUS304 screws: nickel chemical element content won't be less than 8, meets ISO requirement. The finish won't be oxidized, rusted and has good anti-corrosion capacity standard, they won't be broken after 90° bent, high strength, good toughness.

VS



SUS304 screws on the market: nickel chemical element content will be less than 8, even doesn't have nickel plated, which doesn't meet ISO requirement. The finish will be oxidized, rusted and lose anti-corrosion capacity.

FINEX

— 20 YEARS —
**Non-standard Fasteners
Customization Experience**

+86-13527934468

alianchen@finexfastener.com

Contact us

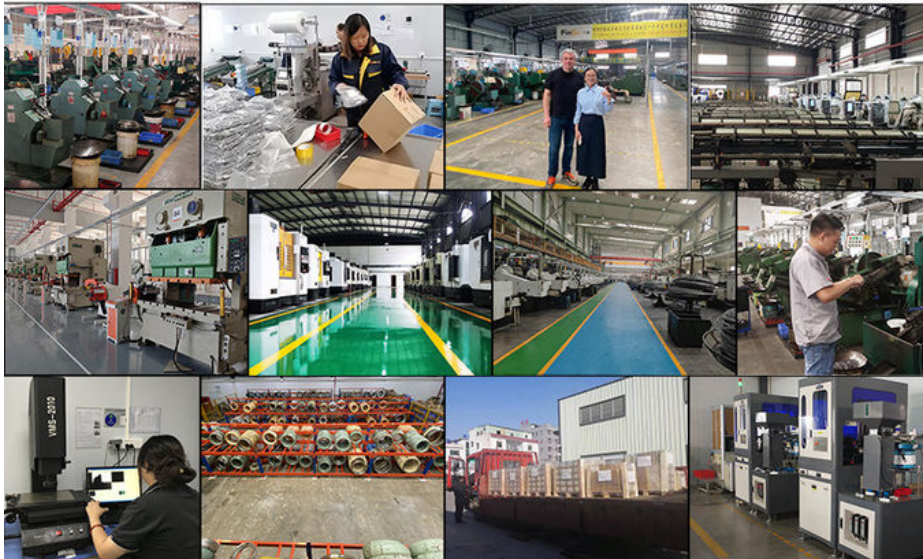

Partners and Exhibitions





FAQ

Q1: What is your main products and material supply?

A1: Our main products are Electronic screws, Sems screws, Tapping screws, Chicago screws, Shoulder screws etc. Special Non-standard studs, Turning parts and High-end precision complex CNC Machining parts etc.

A2: Carbon Steel, Alloy Steel, Aluminum alloy, Stainless Steel, Brass, Copper, Titanium alloy or according to your requirement.

Q2: When can I get the price?

A: We usually offer you a quotation within 12 hours, and the special offer is not more than 24 hours. Any urgent cases, please contact us directly by phone or send email to us.

Q3: What about the transportation and delivery date?

A: If the weight of goods more than 80kg, Normally we use shipment to transport the orders. It is about 20-30 days. If the weight of goods less than 80kg, or there are urgent, we can send the goods via air express, It is 3~5 days.

Q4: What's your packing? What to do in case of damaged goods during transport?

A1: Our Normal packing is bulking in Cartons, less than 20 kgs/carton, 48 cartons / pallet. We also can pack products according to your requirement.

A2: To avoid any subsequent trouble regarding quality issue, we suggest you check the goods once you receive them. If there is any transport damaged or quality issue, don't forget take the detail pictures and contact us as soon as possible, we will properly handle it to make sure your loss to reduce to the smallest.

Q5: Can I get discounts?

A: Yes, for big order, frequent customers, we give reasonable discounts.

Q6: Do you have enough capacity?

A: Our production equipment is a new imported equipment. We have a group of skilled workers who have been working for more than 10 years. Their production experience is very rich and their skills are very skilled. The screws can be 30 million pcs/month. We have sufficient funds to ensure the normal operation of the factory.



Finexpress Precision Manufacturing (dongguan) Co., Ltd



+86-13527934468



alianchen@finexfastener.com



metalscrewfastener.com

Building 2, No. 129 Xinmalian Xinma Road, Dalang Town, Dongguan, Guangdong, China